

Premio 19.5" P-CAP Touch Monitor



FEATURES

- 19.5" Screen size
- Zero-bezel true flat surface
- Anti-glare cover glass
- Slim Design
- Easy integration on and low maintenance
- Projected Capacitive Touch

SPECIFICATIONS

Display

LCD Size	19.5"
HDMI	HDMI x1
Max Resolution	1920 x 1080 FHD
Brightness	250 cd/m ²
Contrast Ratio	3000:1
Display Active Area	434.88 mm x 238.68 mm
LCD Color	16.7M
Backlight Unit	LED
Viewing Angle (H-V)	178/178
Backlight MTBF	40K hours (To 1/2 brightness)
Response Time	25 ms

Touch

Projected Capacitive	Projected Capacitive (PCAP) Touch
Surface Hardness	6H
Multi-iTouch	up to 10 points
Transmission	85%

I/O

VGA	VGA x1
DVI-D	DVI x1
HDMI	HDMI x1
USB	USB (Type B, Touch interface)
Audio	Audio In/Out

Power

Power Supply Voltage	+12VDC ±5%
Power Adapter	100-240VAC, 50-60Hz Input

Environment

Operating Temp.	Temperature: 0 °C ~ 40 °C
Storage Temp.	Temperature: -20 °C ~ 60 °C
Relative Humidity	Operating: Humidity 20% RH ~ 80% RH (Non Condensing)
	Storage: Humidity 10% RH ~ 90% RH (Non Condensing)
Certifications	UL-62368, CE, FCC Class-B, ICES-003, VCCI, RCM

Physical

Bezel Color	Silver on edge, Black on back
Dimensions	490.60 mm × 294.60 mm × 39.60 mm
Weight	Net: 5.6Kg Gross: 7.7Kg
Mounting	VESA Mount 75x75 mm and 100x100 mm

Other Features

OSD	Control(back): Power, Menu, Up, Down, Auto
Warranty	3 Year warranty (Touch screen & LCD 1 year)

* All specifications and photos are subject to change without notice

EXTERNAL POWER ADAPTER CONNECTOR TYPE

NOTES: UNLESS OTHERWISE SPECIFIED.

1. ALL DIMENSIONS ARE IN mm.
TOLERANCES TO BE ± 0.25 mm.
2. PARTS SPECIFIED AS FOLLOWS:
 - 2-1. ENCLOSURE:
 - * MEET V-0 FLAMMABILITY.
 - * COLOR: BLACK.
 - * TEXTURE: MOLDTECH MT11020.
 - 2-2. AC RECEPTACLE:
 - * IEC 320, C14 CERTIFIED, 3 WAY.
 - * COLOR: BLACK PER MAKER.
 - 2-3. DC OUTPUT:
 - * PLUG INSULATOR: BLACK.
 - * PLUG POLARITY: (+) \rightarrow (-)
- * CABLE: UL/CSA, AWM 1571, VW-1, 80°C, 20AWG.
- * JACKET COLOR: BLACK.

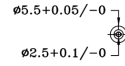
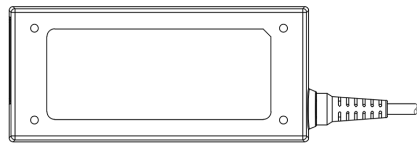
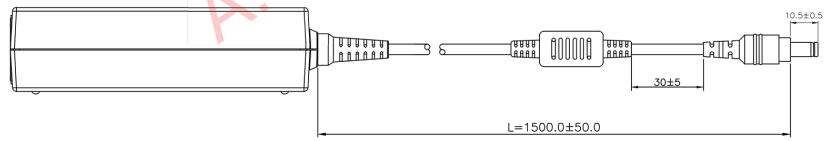
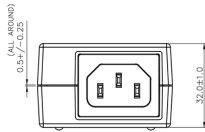
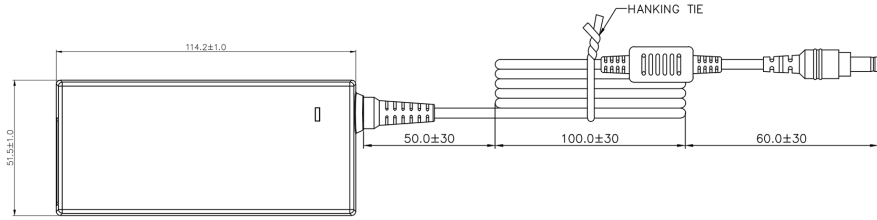

DIMENSIONS

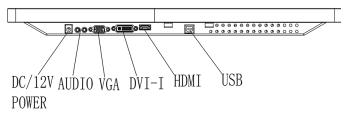
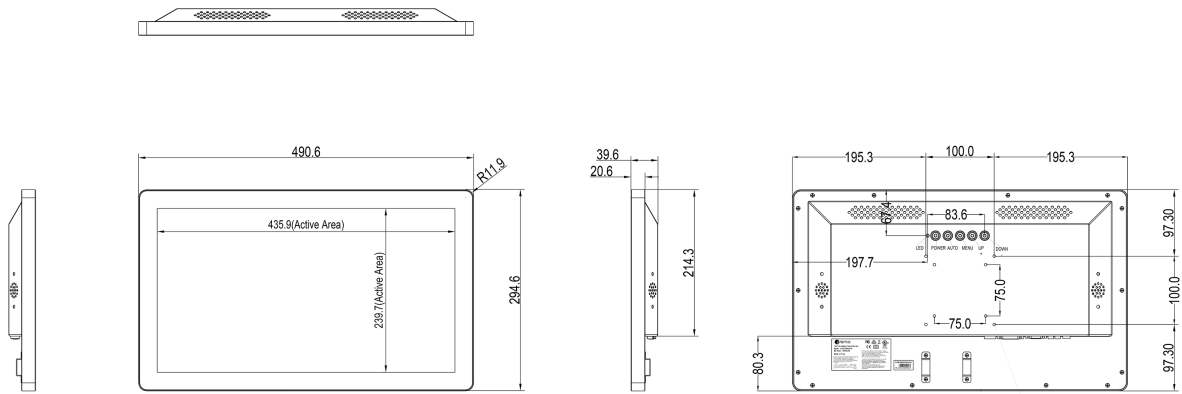

M4 Threads, X8
Max Screw Depth=9mm
From Mounting Surface

ALL DIMENSIONS ARE IN MILLIMETERS

AVAILABLE MODELS

MODEL NO.	DESCRIPTION
PI-ZB195P25FH02-ARA	19.5" P-CAP Touch Monitor, 1920 x 1080, 16:9, 250cd/m2,3000:1. 3 year warranty (touch screen & LCD 1 year)

PACKING LIST

- 1 x Touch Monitor
- 1 x AC/DC Power Adaptor
- 1 x Power Cord
- 1 x USB Cable
- 1 x VGA Cable